

Help pages

1 « regularity » page (main page)

Configuration button
(appears when pushed)

Push to change page

Main page outside of RT

Stop or reverse

Change speed (simu mode)

Vehicle Speed

GPS reception quality

Trip1 (push to correct)

Push for RT management page

Imposed speed in next ZR

Chrono, push to start or stop

Push to cancel correction

Annotations on the screenshot include: RND, v-, Km/h, 38, 48.32, 0:00:00, 16:50:50, 1 Zr, 2 Cr, Annule correction Undo, 1, 12, 1, 2, and Km.

Bargraph:
yellow-red: accelerate
blue-green: slow down

Recommended speed (avoids the yo-yo)

Advance (green) or delay (red)

Background changes color like end of bargraph

Distance corrections from bottom to top (with cumulation)

Main page during RT

Segment compulsory speed

Segment in progress

RT in progress

Next GPS correction

Annotations on the screenshot include: Km/h, 48, 50.00, 54, 0:00:09, 0.3, 2 Zr, 2 Cr, +8 (8) m., +3 (11) m., +5 (12) m., -2 (10) m., 1 Se, 1, 8, s., 1, and Km.

2 Trip modification

Numbers for direct modification

Frozen distance (black) or modified (blue)

Delete

Trip in modification (continues to run)

Apply the gap (correction of the frozen value, not in beginner mode)

Write the new prepared value (when pushed)

Correction value

Add or subtract 1 or 10 m.

Close without modification

Annotations on the keypad include: 7, 8, 9, 122.896, -0.104, 4, 5, 6, + 1, + 10, 1, 2, 3, - 1, - 10, 0, ., ←, Apply gap, New value, 123.000, Km, Help, and ↩.

3 Stopwatch

Start chrono manually **Push to switch to auto start on time**

Check to switch to circuit mode



then...

... push the chrono value to make appear the "Stop" button

Manual start



Use the "Stop" button to stop the timer

Close

2: close and wait for start time **Desired time for automatic start**

Check to switch to circuit mode



then...

... push the chrono value to make appear the "Stop" button

Start automatic on time

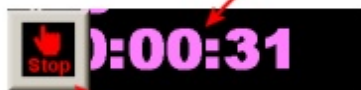

Use the "Stop" button to stop the timer

1: choose auto start time (per 1' for beginners)

1: check

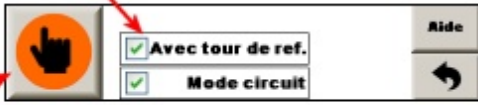

2: start at the beginning of the reference lap



then...

...push the button when passing on the chrono line (press chrono value if button disappeared)

Number of laps

0: reference lap



Use the "Stop" button at the end of the last lap

Circuit mode with reference lap

1: uncheck

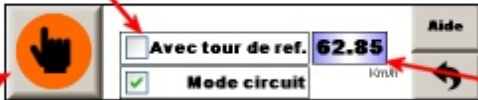

2: enter the speed imposed, measured or calculated

3: start on the chrono line

then...
...push the button when passing on the chrono line (press chrono value if button disappeared)

Number of laps → 4

Use the "Stop" button at the end of the last lap

Circuit mode without reference lap

00:28

00:00

4 « pilot » page

Configuration button (appears when pushed)

Vehicle Speed

Recommended speed (avoids the yo-yo)

Average speed for the segment

Push these areas to change page

Trip1 (push to correct)

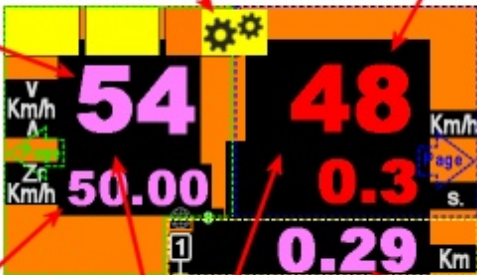

5 « link » page

Configuration button (appears when pushed)

Time

TC hour (push to adjust)

Vehicle Speed

Battery voltage

Trip2 (push to correct)

Push these areas to change page

Remaining time

Remaining distance

Average speed to arrive on time



set ideal TC hour:

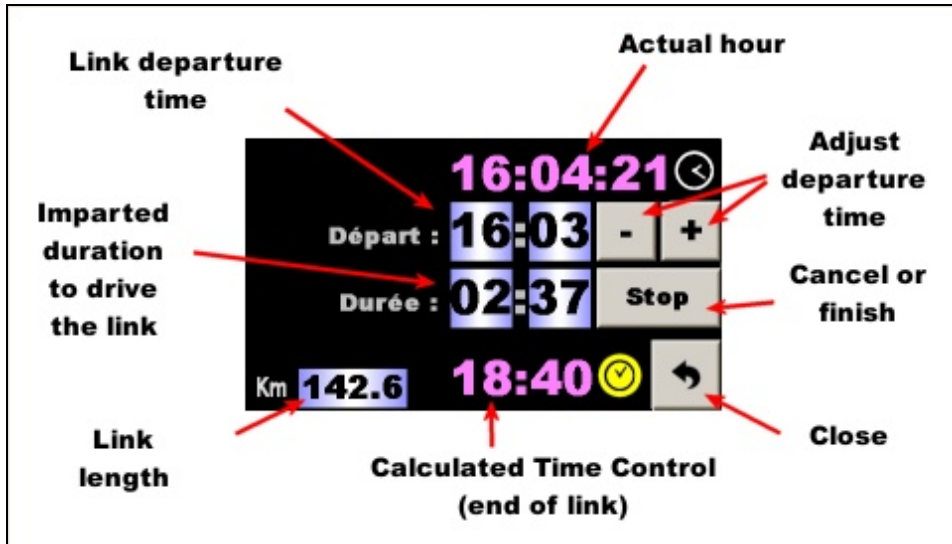

6 Configuration

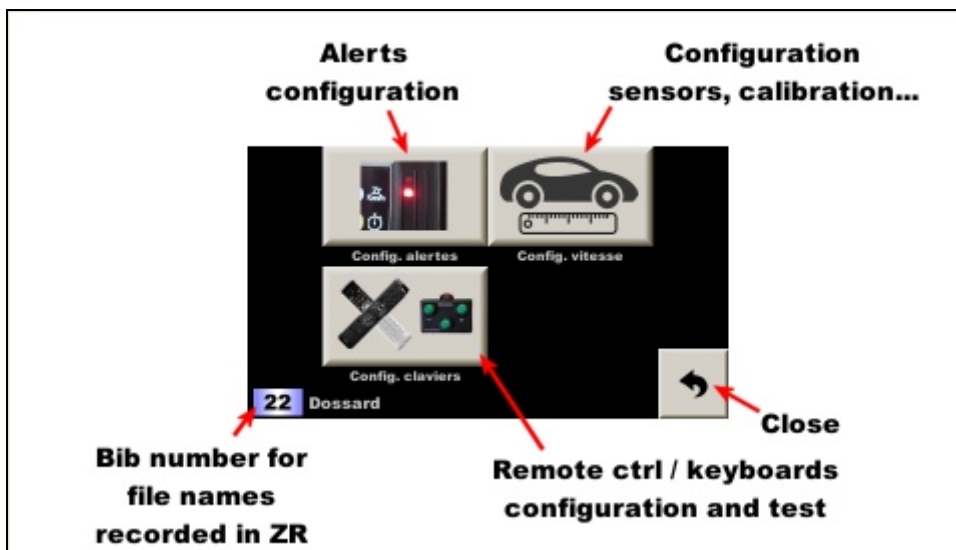
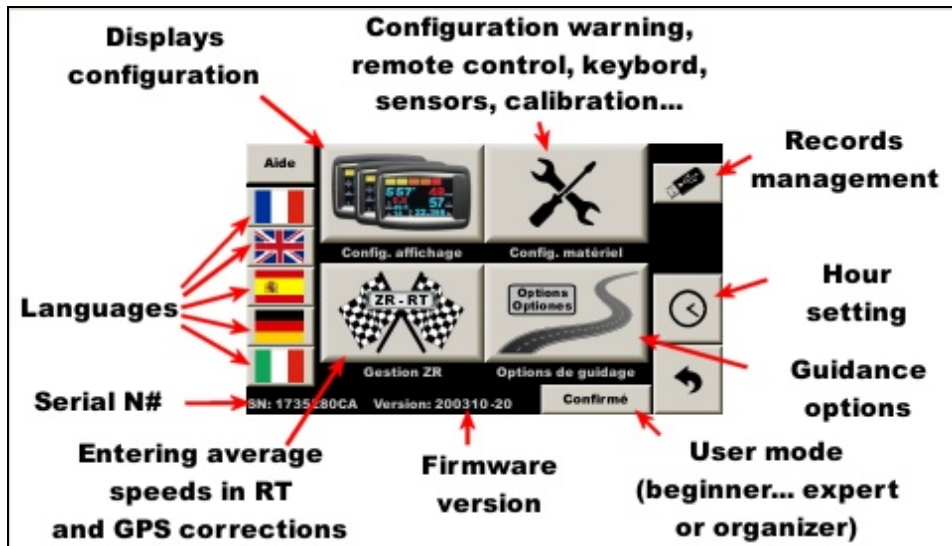

6.1 Infrared remote control and button box configuration and test

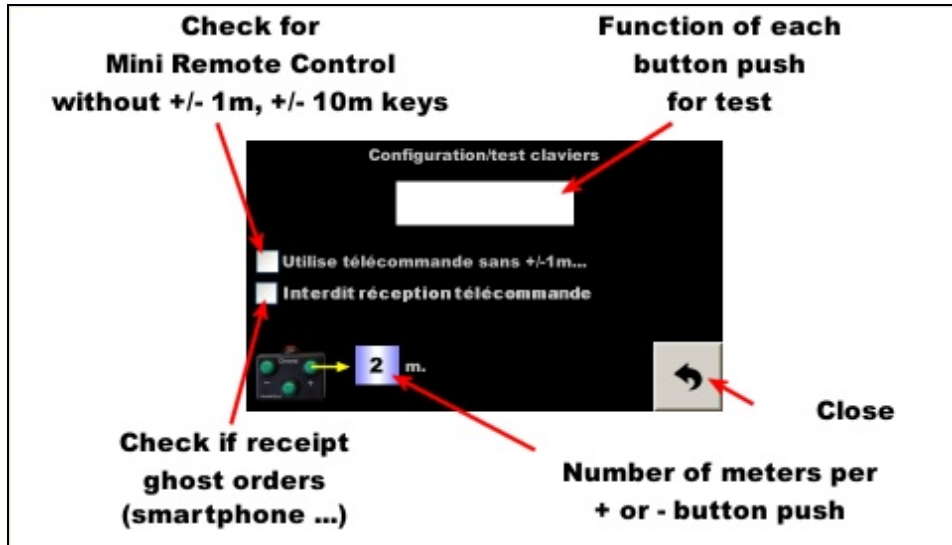

6.2 Sensors configuration, calibration...

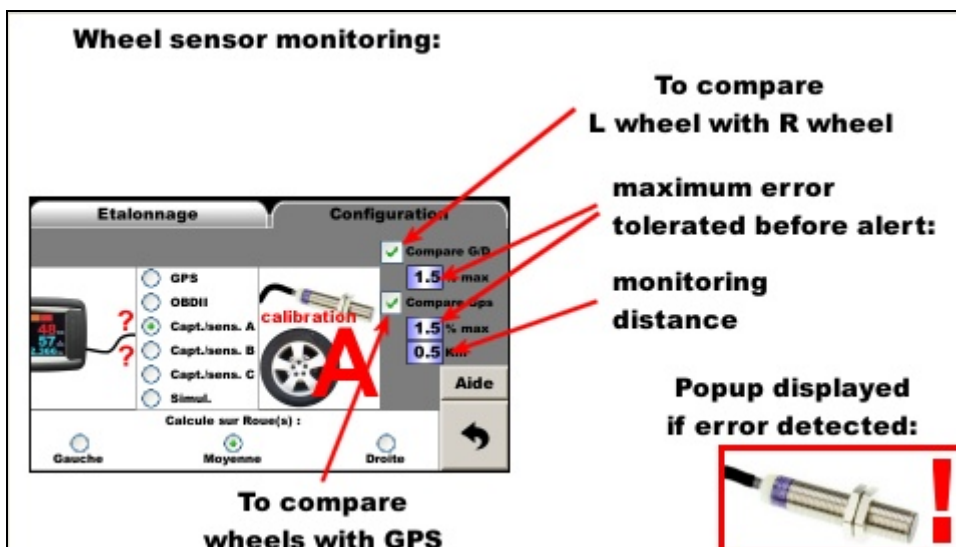
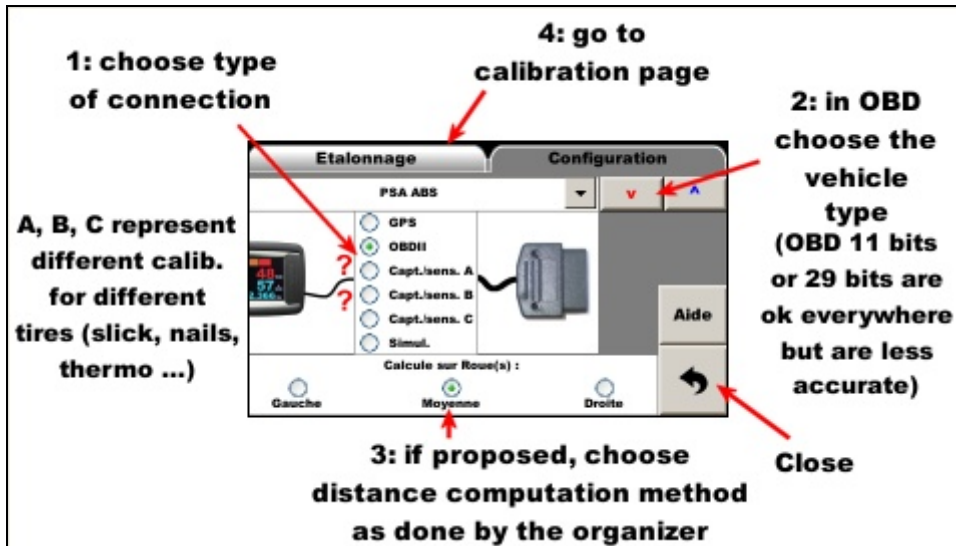

Tires centrifugal swelling compensation (expert mode)

Display calibration history

Edit calibration on the fly or bt +/- 1m (except beginner mode)

Type here the calibration value, if it is already known

Close

Coefficient to apply to calibrations

Wheel or OBD calibration

Add or remove 0.1 m. per km (key +/- 1 m. remote control)

Paste coef. of normalization or manual corrections

GPS calibration (check box previous page)

Add or remove 1 m. per km (key +/- 10 m. remote control)

Validate

Cancel

new

1: choice of Trip1 or 2 or a distance freely copied (compute without drive)

2: Reset at calibration zone start

3: drive the zone or type in the distance

5: compute

Calibrate the GPS at same time

4: Type calibration distance given by the organizer

Close

In "sensor" mode, for GPS based calibration (fast but not very precise):

1: click GPS mode

2: drive in straight line

3: compute while driving

Connection configuration (sensors, OBD, GPS...)

Check each sensor pulses (if available)

6.3 Distances/speed management during RT

RT are recorded in files

Theoretical chrono at the end of segment

RT choice

MultiSpeeds mode

One line for each speed (segment)

Scroll the lines

Close

km of beginning and end of segment

Speed on the segment (km/h)

Trip1

Ind	Début	Fin	Vitesse	Temps
1	0.000	3.658	48.32	4:32.5
2	3.658	5.215	46.36	6:33.4
3	5.215	8.698	49.99	10:44.2
4	8.698	12.375	47.02	15:25.7

0.000 Km

'Gravel crew' or semi-auto corrections notes

GPS auto-corrections

New RT

Save RT

Import from USB export to USB

Delete ALL data of ALL RT

Modify the shifted start distance during RT

modified

6.4 Automatic corrections by GPS

Points are recorded in the file at each addition

Duplicate (if multiple passages in the race)

Configuration

Files information

Total number of points

Scroll the lines

Distance since last green and yellow point

Delete the last point

Trip1

GPS reception quality

New file

Adjust distances

Supprime

Ajoute inter

Ajoute absolu

Auto Km

0.000 Km

60

0.100

ZR:1

Nbr : 336

Ind	Km	Latitude	Longitude	Commentaire	Début
334	49.214	44.376884	5.514539	d949	
335	53.237	44.387955	5.485857	d994	
336	53.880	44.388878	5.478682	Rosans	
	-53.880	44.163284	1.552415		
	-53.880				

modified

GPS points manual entry

1: type a comment (optional)

2: add a point after tight turn, or ... (limited distance correction)

... add a point without correction limitation (not after tight turn)

ZR:1

Nbr : 336

Ind	Km	Latitude	Longitude	Commentaire	Début
334	49.214	44.376884	5.514539	d949	
335	53.237	44.387955	5.485857	d994	
336	53.880	44.388878	5.478682	Rosans	
	-53.880	44.163284	1.552415	comment	
	-53.880				

0.000 Km

60

0.100

GPS points automatic entry (road without tight turn)

1: type distance between two points

2: check

It remains possible to enter a point manually between 2 automatic points

ZR:1

Nbr : 336

Ind	Km	Latitude	Longitude	Commentaire	Début
334	49.214	44.376884	5.514539	d949	
335	53.237	44.387955	5.485857	d994	
336	53.880	44.388878	5.478682	Rosans	
	-53.880	44.163284	1.552415	comment	
	-53.880				

0.000 Km

60

0.100

Text generated by buttons

Keyed text

Number pad

Close without modification

Validate

Function keys

Auto-incremented n° (Road-book box for example) Modified with +/- 1 m keys.

The screenshot shows a menu with the following options:

- 1 : Danger virage
- 2 : En face
- 3 : Danger trou / bosse
- 4 : A Gauche
- 5 : Poteau
- 6 : A droite
- 7 : Panneau inversé
- 8 : Pylone
- 9 : Panneau
- * : Arbre
- 0 : Borne
- Exit
- Ok

At the bottom, there are function keys: a red left arrow, a green right arrow, a yellow 'Entrée' key, a blue 'C3' key, and a grey 'Ok' key.

modified

If start before: add a positive distance to all points

If start after: add a negative distance to all points or make a shifted start

After addition, it is necessary normalize if distance total unchanged

Multiply all points by a coefficient (never used)

The screenshot shows a settings menu with the following options:

- ZR:6
- Longueur : 12.214 km
- Nbr : 123
- Aide
- Ajoute -> 0.000 Km
- Multiplie par -> 1.000000
- Normalise à -> 12.214 Km de fin
- A partir du point : 1 0.000 Km
- Exporte en GPX
- Garmin
- Google

1: type distance exact of the box

Match to a road-book box:

3 : push button

2: check that it corresponds to the previous correct point (not in beginner mode)

4: button to adjust calibration if necessary

The screenshot is the same as the previous one, but with annotations:

- Red arrows point to the 'Ajoute ->' field (0.000), the 'Normalise à ->' field (12.214), and the 'A partir du point : 1' field.
- A red arrow points to the 'Exporte en GPX' button.
- A red arrow points to the 'Garmin' and 'Google' selection buttons.

modified

**Exporting files
in GPX format**

2: choose points style for:
- Garmin Basecamp
- Google Earth

1: check to add the yellow / green dots in the file

3: export the points in a file copied with GPS files

Maxi error corrected by green point

Correction flash:
- less than 6 m: green
- 6 to 30 m: yellow
- more than 50 m: red

If this distance without correction, then display "GPS Magic" button

Validate the check "auto Km" after entering a point

Buttons assignment

Use the keyboard to capture the GPS correction points

new

6.5 'Gravel crew' notes management

Points are recorded in the file at each addition

Delete the last point

Total number of points

Scroll the lines

New file

2-button for semi-auto correction or button for difficulty

1-Enter distance: keyboard or remote control

Distance to anticipate the announcement

6.6 Date / hour setting

with GPS auto-synchronisation:

Paris time zone: GMT + 1 h in winter GMT + 2 h in summer

Offset to match to the organizer clock (except beginner mode)

Uncheck for a manual setting

Synchro beeps every second (looking at time orga.)

Close

Reset to 0 all offsets

manual setting:

Changing the minutes sets seconds to 0

Check for a GPS auto. setting

Offset to match to the organizer clock (except beginner mode)

Close

6.7 Guidance options

Beep: low tone to slow down or acute to accelerate

Speed difference guidance is recommended to avoid the "yo-yo" effect

Check if pilot screen connected

Increase for less of beeps, but less accurate (not in mode beginner)

When T1 reset to 0 makes T2 reset to 0

Enable the notes for semi-auto correction or 'gravel crew' notes

Windshield LEDs power

Reverse red/green on windshield LEDs

Reverse red/green on screen

Close

Enable the automatic correction by GPS

Automatic start detection by GPS

Info on distance differences compared to GPS (expert mode)

Check if T1 is not reset to 0 at RT start

modified

6.8 Display configuration

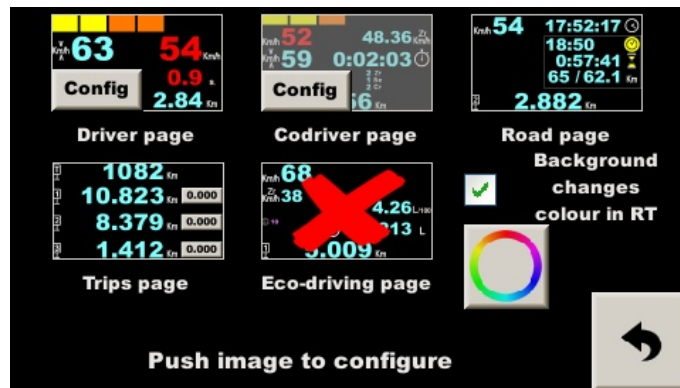

Press the color palette button to set the text color:

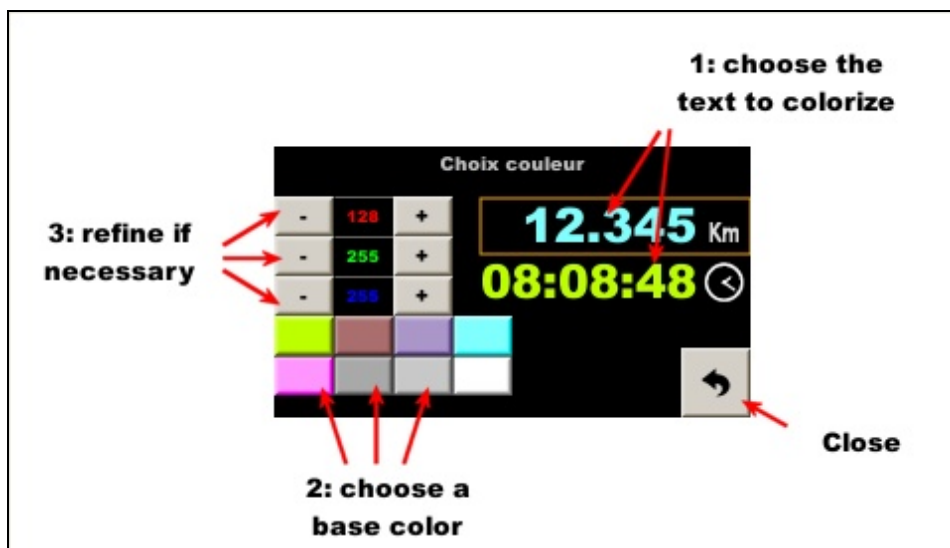

« codriver » page, remove some information pressing on images:

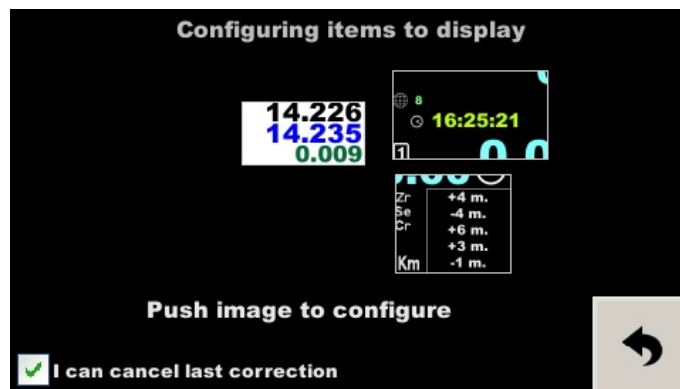

« pilot » page (configures also RP380/400 if connected):

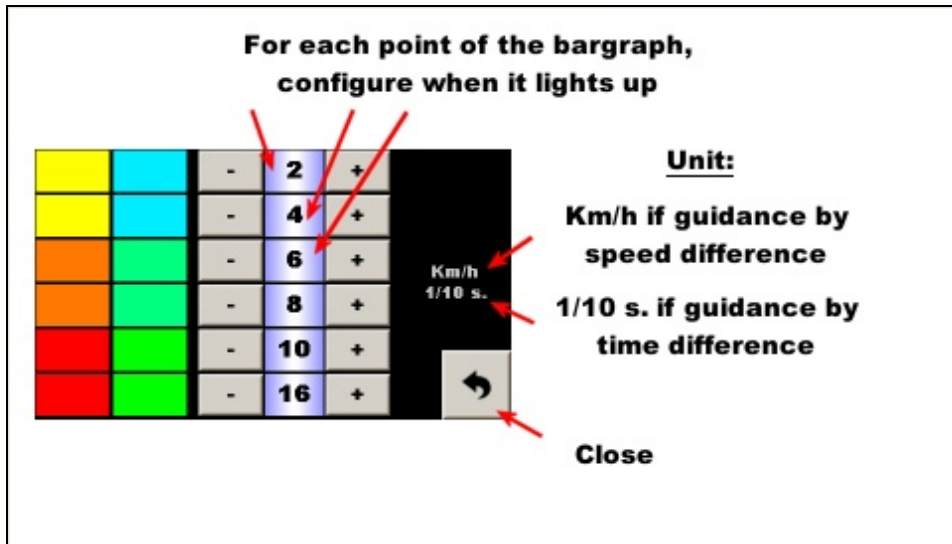
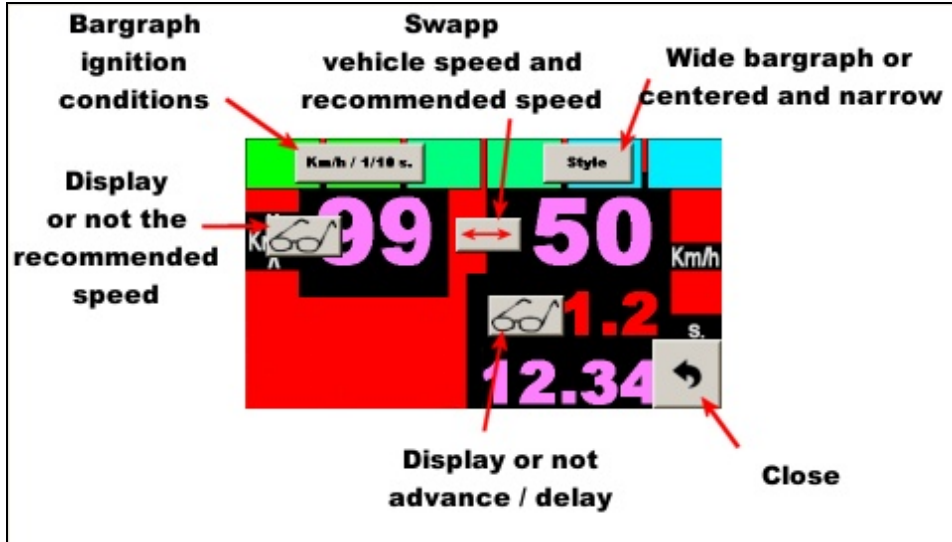

6.9 Files recording

Press to record. Recording starts when Trip1 is set to 0

Check to record a extra NMEA file

Distance between 2 recorded points

Number and size of files in memory

After plugging in a USB drive, press to access the screen of archive file management

Close

RT preparation files:

- average speeds
- GPS corrections
- 'gravel crew' notes
- GPX (export only)

Other recorded files:

- during the race
- during scouting
- calibrations ...

Copy / delete archive files (if exist on internal disk)

Software update (if found on the USB drive)

modified